

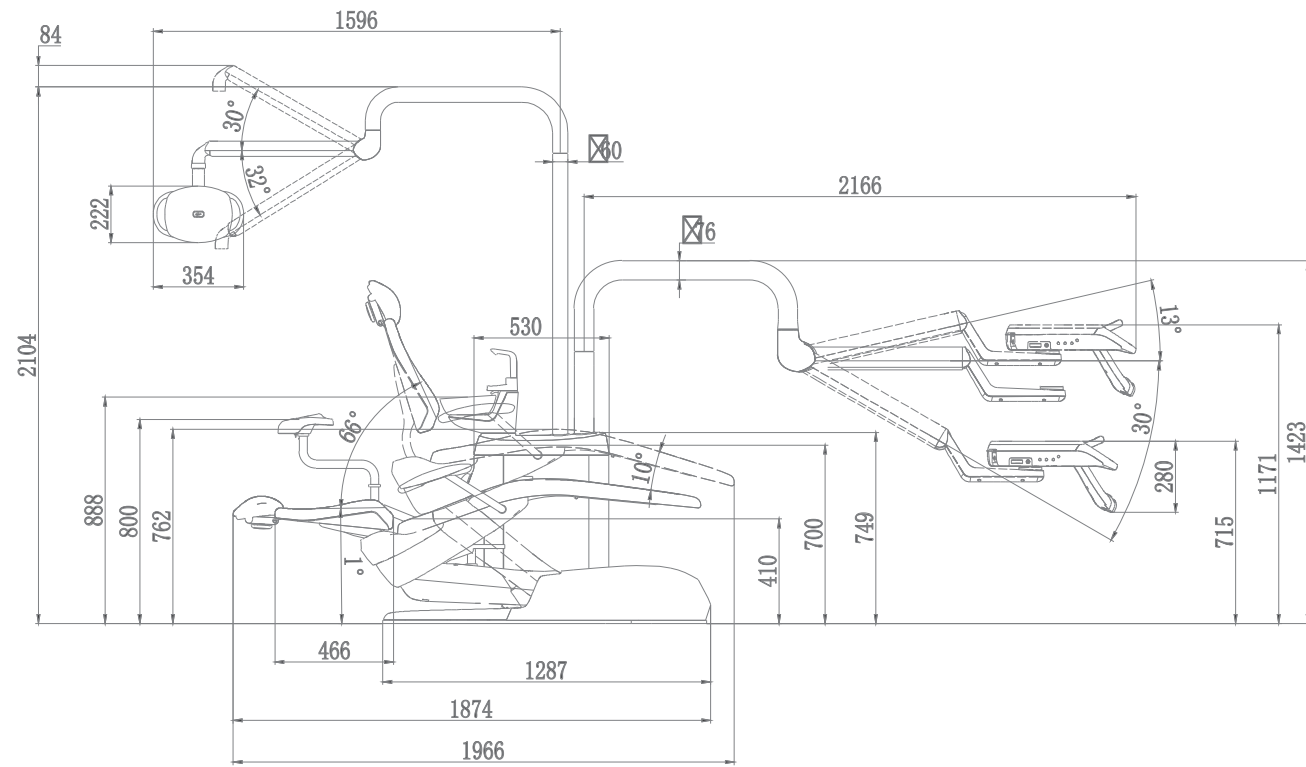

Dimensions Units: mm

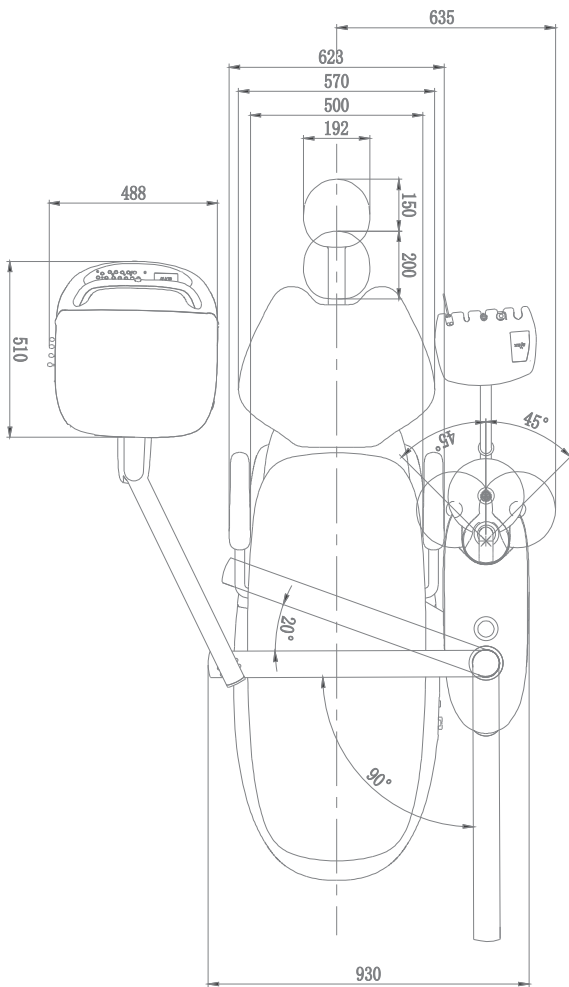

HEADQUARTER

 Ajax Dental Supplies Pty Ltd.

📍 Headquarter ADD: Unit 23 / 21 Merrindale Drive, Croydon South VIC 3136
NSW Branch: Shop 8 / 108 Queens Road, Hurstville NSW 2220

 www.ajaxdent.com.au
 info@ajaxdent.com.au

Tel: 03 9879 3801
After sales hotline: 0493 979 543



AJ21

Four Minutes

About AJAX

Founded in 2007, AJAX now employs over 400 staff and specializes in the R&D, manufacturing, and sales of high-end dental units. Guided by the philosophy of “pursuing excellence in dental equipment,” AJAX operates with independent R&D capabilities, strong technical expertise, efficient production lines, and strict quality-control processes. Our annual production capacity has reached 30,000 units, and we have obtained major global certifications, including FDA (U.S.), TGA (Australia), JIS (Japan), and CE (EU). AJAX products are distributed across the United States, Western Europe, and more than 100 countries worldwide. Supported by our “rapid response, mission must be accomplished” after-sales service ethos, we ensure a worry-free experience for clinicians and partners. Today, AJAX has become a trusted global choice with over 100,000 users.



Reliable Quality

90% of our dental chair components are independently developed and manufactured by AJAX, ensuring rigorous quality control at every stage of the production process.

Quick Response

We listen attentively to each customer’s needs and continuously enhance our products and services in a timely manner.

Continuous Innovation

Our team possesses strong research and development capabilities in dental chairs, stays aligned with industry trends, and remains committed to independent innovation.

Quality Service

Our qualified technicians deliver comprehensive, professional solutions for clinics, and our global service network ensures rapid delivery of chair components.

AJ21 Floor Mounted

Professional dental practices place high demands on the patient comfort and efficient operation of dental units, and the unique features of the AJ21 Floor Mounted have been designed to meet the needs of such clinical specialties.



Stable floor Mounted box

Three-sided aluminum alloy side box, durable, with plenty of side box space; water, air and elec-tricity independent layout design, meets the Euro safety standards.



Underslung flexarm

Comfort and Ease of Operation



- The suspended light arm requires less upward pull and allows for precise positioning.



- The suspended level arm offers flexible control and effortless adjustment, providing a greater range of up and down motion.

Intelligent Control System



Function-rich Operation Panel

- Timer on screen
- 6x4 group chair programs
- System starts self-checking
- Scaler control
- Frenclenburg position
- Fiber Optic handpiece light switch
- Endo function mode
- One-button Trendelenburg Position
- Disinfection process monitoring
- Water temperature control
- One-button water source switch
- Micromotor control (Includes endodontic mode)



Top Status Bar

Micromotor speed (Endo mode)

Fiber Optic Handpiece

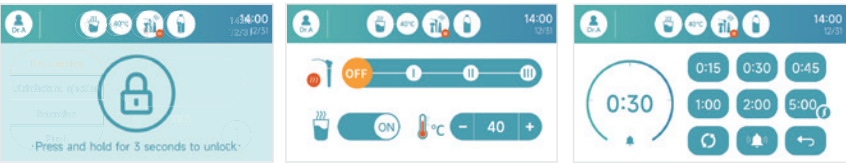

Lock Screen Interface

Water Temperature Regulation

Chairside Timing

Full-Automatic Disinfection System.



Start Disinfection with One Button

- To complete the overall Disinfection.

All Waterline Covered

- Avoid any omission.

Free Your Hands

- Reducing the workload of the dental team.



With just one click, simply prevent cross-infection and meet the infection control requirements for all the waterlines throught out the dental chairs.

Standardized Disinfection Process, effortless and time-saving.

Patient Chair



Comfort Brand New Fan-Shaped Backrest

Exquisitely designed, it offers a great sense of space and comfort, providing better support and facilitating more efficient collaboration between medical staff.



Forward-Turning Armrest

T-shaped forward-tilting armrest which is easy for patients to get on and off the dental chair.



Nappa Upholstery

Fine texture, silky touch, elasticity, fresh and breathable, all-round to fit the body curve. Corrosion-resistant, anti-aging. anti-brittleness.



Suitable For Any Height

The lowest chair position is **385mm** and the highest chair position is **825mm**. The application of ergonomic design makes the dental chair extremely harmonious with the human body.



Handwheel-adjustable headrest

Handwheel-adjustable headrest for firm head support, flexible angle adjustment and Flatter Knob.

Delivery Unit



Ergonomic delivery system

The delivery system with a 3.2-inch LCD screen, large size dentist tray 480*380mm with sterilizable silicone pad.

High-quality materials

High-quality materials, able to withstand high-frequency sterilization.

Effortless Handpiece Holder

The instruments are angled to fit the doctor's hand and require very little force.

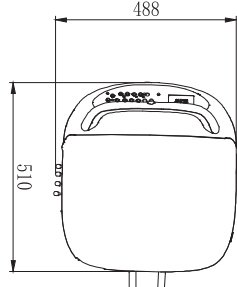

Micromotor control (TKD NUCLEUS®LED, Made in Italy) Scaler control (Woodpecker build in UDS-N6 LED)



Continental Delivery System (Optional)

Omni-directional rod, Its flexibility extends the operating space. 0 gravity grip, No fatigue during continuous operation.





Hubble II LED Dental Light (with composite mode)

Illumination
8000Lux~40000Lux



Exceptional Clarity

Four LED light groups with an ultra-high color rendering index to restore the natural color of the tooth.

Uniform Illumination Intensity

Internal light-mixing technology ensures perfectly even illumination intensity.

Stepless Adjustment

Three modes: white light, yellow light, and mixed light, with stepless adjustment of illuminance.

In-Built 1080P camera recording system (Optional)



High-Definition Image Capture

Features one integrated SONY 4K camera, and image processing technology. It records in 4K resolution with HDR and automatically stores data in the external hard drive.

Smart Focus Technology

Auto/manual focus switching with precise positioning for flexible operation.



Coaxial Recording System

Uninterrupted lighting and filming, perfectly angled to capture surgical procedures.

Synchronized Voice Recording

Automatically captures audio narration during filming, ensure comprehensive documentation with no detail overlooked.

Side box



1300ml + 1700ml Water Bottles

Separate purified water bottles and disinfection water bottle for easy operation.



Assistant Unit

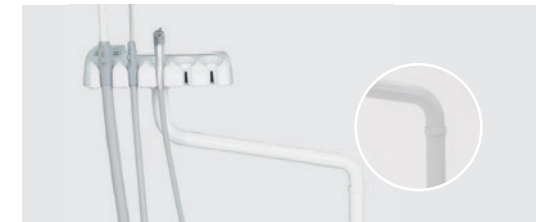

Double Joint Assistant Unit with Control Panel

An assistant unit with a multifunctional control pad will enhance your efficiency.



Spin-on Filter

Spin-on type, locking and sealing structure, rotate to lock, simple and easy to operate.



Ultra-light Handle

Ultra-light HVE and SE handle. Air tightness is increased. Suction is stronger and more stable.



Rotatable Glass Cuspidor

135° rotatable ceramic spittoon bowl, removable for sterilization, effectively isolates sewer odors.

Foot Control



Multifunctional Foot Switch

Premium multi-function foot pedal, easy for dentist to handle, water and air are controlled by different pedals.

- | | | |
|---------------|----------|--------------|
| 1. Cool water | 2. Air | 3. Chip blow |
| 4. Lamp | 5. Chair | 6. Rinsing |
| 7. Filling | | |

D3 Doctor Stool N4 Assistant stool



Six adjusting functions. The caster frame is made of precision aluminum alloy casting, and the casters are made of silent wheels.

Options



Multiple Color Options Available for Your Choice



Configuration

Operating System	AJAX Intelligent Control System (3.5 inch Touch Screen)
	Safety Switch
Infection Control	Full- Automatic Disinfectant System
Dental Light	Hubble II (with composite mode)
Chair	Nappa Upholstery
	Metal Chair Frame
Delivery System	Silicone Anti-slippery Pad
	3.5 inch Touch Screen
	Mater Air/Power/Water Switch
	1 Triplex / 2 High speed lines with light
	TKD Electric Motor with Endo function
	Woodpecker Scaler UDS N6 LED
Assistant Unit	Double Joint
	Assistant Control Panel
	1 HV and 1 SE suction line / 1 triplex
Side Box	Floor Mounted Side Box

Side Box	1300ml Disinfectant Bottle
	1700ml Water Bottle
	Detachable Glass Cuspidor
	Hydrolytic Resistance Waterlines
Foot Control	FT-6A Dual Pedal Foot Control
Junction Box	Built-in service box with air/water filters and Regulators
	Sealed Drainage Device
Doctor Stool	D3 Doctor Stool
	N4 Assistant stool
Options	Monitor 22'
	Monitor wireless connection Kit
	Monitor Arm
	Spittoon Valve
	High Speed couplers and handpieces
	Slow speed handpieces
	HD Camera Record system (built in to the light)